

CUSTOMER		
ORDER No.		
SERIAL No.		
FRAME SIZE		
Kw	R.P.M.	
Hz	PHASE 3	
VOLTS	POLES	
BRGS.	D.E	N.D.E
MOTOR NETT. WT.		Kg.
INSULATION CLASS		
TEMPERATURE RISE °C		
DESIGN AMBIENT TEMPERATURE °C		
HEATER WATTS & VOLTS (IF FITTED)		
- WATTS, - VOLTS		

REMARKS
 EEx de IIB
 BASEEFA CERTIFICATE
 No. Ex98E1111X
 or
 EEx de IIC
 BASEEFA CERTIFICATE
 No. Ex98E1112X

ALL DIMENSIONS IN MILLIMETRES

FIRST ANGLE PROJECTION

NOTE:-
 CABLE ENTRY CAN BE
 SUPPLIED IN ANY ONE OF FOUR
 POSITIONS AT 90 ° INTERVALS.

NOTE!
 STANDARD MACHINES ARE ARRANGED FOR HORIZONTAL OVERHUNG MOUNTING.
 CUSTOMERS SHOULD NOTIFY US WHEN ORDERING IF VERTICAL MOUNTING
 IS REQUIRED. IF VERTICAL, THE MOTOR THRUST BEARING MUST NOT BE
 ALLOWED TO TAKE ANY LOAD OTHER THAN THE WEIGHT OF THE ROTOR
 WITHOUT OUR APPROVAL.

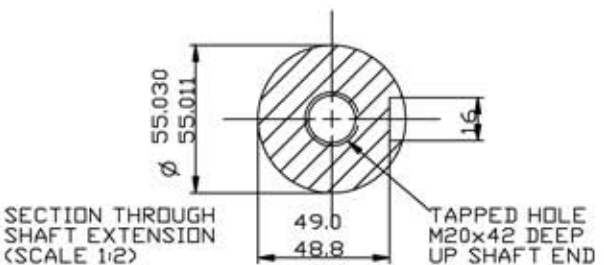

NOTE!
 2.5 ENDPLAY WILL BE PROVIDED FOR ENDTHRUST
 PROTECTION WHEN CUSTOMERS NOTIFY US OF THEIR
 INTENTION TO USE RIGID COUPLINGS AND DRIVEN
 MACHINES WITHOUT ENDPLAY.

OUTLINE DIMENSIONS OF STANDARD FLANGE MOUNTED METRIC
 A.C MOTOR TO BS4999 PART 141 T.E.F.V. EEx de TO EN50014/18/19
 FRAME W-EF200LN-D

SCALE	1:6	DATE
DRAWN	JML	5/5/97
CHECKED	JML	5/5/97
APPROVED	IJW	5/5/97

DRG. No.	M70010		
REVISION:	A M.E	DATE	30.4.98